

NOTE: EXISTING-UNDERGROUND UTILITY LOCATIONS ARE APPROXIMATE ONLY. CONTACT UNDERGROUND SERVICE ALERT AT 1-(800) 227-2600 48 HOURS PRIOR TO ANY DIGGING.

RECORD PROPERTY LINE PER LAKE ORINDA HIGHLANDS (20 M 530)

UNAUTHORIZED CHANGES AND USES: The Land Surveyor preparing this map will not be responsible for, or liable for, unauthorized changes to (or uses of) this map. All changes to this map must be in writing and must be approved by the preparer of this map.

LEGEND

- . . . DENOTES FD. IRON PIPE AS NOTED.
- FH . . . DENOTES FIRE HYDRANT
- EP . . . DENOTES EDGE OF PAVEMENT
- WP . . . DENOTES SURVEY WORK POINT
- X . . . DENOTES SURVEY SHOT
- [Pattern] . . . DENOTES EXISTING BUILDING.
- JP . . . DENOTES JOINT UTILITY POLE
- TC . . . DENOTES TOP OF CURB
- WM . . . DENOTES WATER METER
- GM . . . DENOTES GAS METER
- EM . . . DENOTES ELECTRIC METER
- MB . . . DENOTES MAIL BOX
- OHW . . . OVER HEAD UTILITY WIRES
- GB . . . DENOTES "GRADE BREAK"
- DL . . . DENOTES "DRIP LINE" OF TREES.
- TW . . . DENOTES TOP OF WALL
- BW . . . DENOTES BOTTOM OF WALL
- FW . . . DENOTES FENCE- WOOD
- FC . . . DENOTES FENCE-CYCLONE

SPENCE
(2002-105104)
LOT 30
BLOCK 'N'
LAKE ORINDA HIGHLANDS NO.1
(20 M 530)

LOT 29
(20 M 530)

LOT 31
(20 M 530)

CHAPARRAL PLACE
(40' R/W)

EL TOYONAL
(40' R/W)

BASIS OF BEARINGS

FOUND IRON PIPE MONUMENTS IN EL TOYONAL PER THE MAP OF LAKE ORINDA HIGHLANDS (20 M 530), CONTRA COSTA COUNTY RECORDS: BEARING TAKEN AS: NORTH 23°46'00" WEST.

BASIS OF ELEVATION

ASSUMED DATUM.

BASIS OF MEASUREMENT

DIMENSIONS IN U.S. SURVEY FEET.
1 US SURVEY FOOT = 0.304801 METER.
1 METER = 3.280833 US SURVEY FEET.

FIELD DATA

FIELD BOOK 494, PAGES 14-15, DATED 10-02-2003.
FIELD BOOK 501, PAGES 33-37, DATED 8-27-2004.

#372 EL TOYONAL, ORINDA, CA. APN 264-091-013 (610 E 7) JOB NO. 484-03 (SPENCE)

11-03-04
DATE: 9-14-04

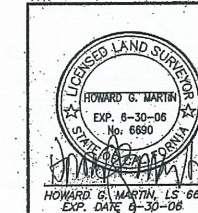

TOPOGRAPHY MAP
A.P.N. 264-091-013
#372 EL TOYONAL
CITY OF ORINDA
CONTRA COSTA COUNTY, CALIFORNIA

SCHELL AND MARTIN, INC.
LAND SURVEYING AND CIVIL ENGINEERING
3377 MT. DIABLO BOULEVARD
LAFAYETTE, CALIFORNIA 925-283-8111

Prepared at the request of: MARGARET SPENCE
% 2010 SOUTH LA ROSA DRIVE
TEMPE, AZ 85282

BY: GS FB: 494 PG: 14-15 JOB# 484-03
DATE: 9-14-04 SCALE: 1" = 10' SHEET 1 OF 1

